

10,000,000 CANDLE POWER RECHARGEABLE SEARCHLIGHT & POWER STATION

Welcome

This product has been carefully engineered and manufactured to give you dependable operation. Please read this manual thoroughly before operating your new product as it contains the information you need to become familiar with its features and obtain the performance that will bring you continued enjoyment for many years. Please keep this manual on file for future reference.

SAFETY INSTRUCTIONS

WARNING:

1. **ALWAYS** unplug Spotlight and allow light to cool before replacing bulb.
2. If exposed skin feels warm while you are in the lighted area, move the light farther away from the work area.
3. **DO NOT** look directly at the lighted bulb, severe eye damage could result.
4. **ALWAYS** keep the light away from any materials or surface that could burn.
5. **USE ONLY** with bulbs rated on the Model Identification Label or smaller bulbs.
6. **NEVER** touch bulb surface with your bare hands.
7. **DO NOT** operate light if it has a missing or damaged metal grill or glass lens.

Location of Controls

1. Rocker Switch (On/Off/Dimmer)
2. Carry Handle
3. Knob for Vertical Adjustment
4. 12V Power Cord
5. AC / DC Charging Jack
6. Pivot Bracket
7. Power Station
8. Battery Level Button
9. BI-color Battery Indicator
10. Lens
11. Super Beam H4 12V 100W Halogen Bulb
12. 12V Power Jack
13. 12V Power Port
14. Cushioned Metal Stand
15. AC Charger
16. DC Charger

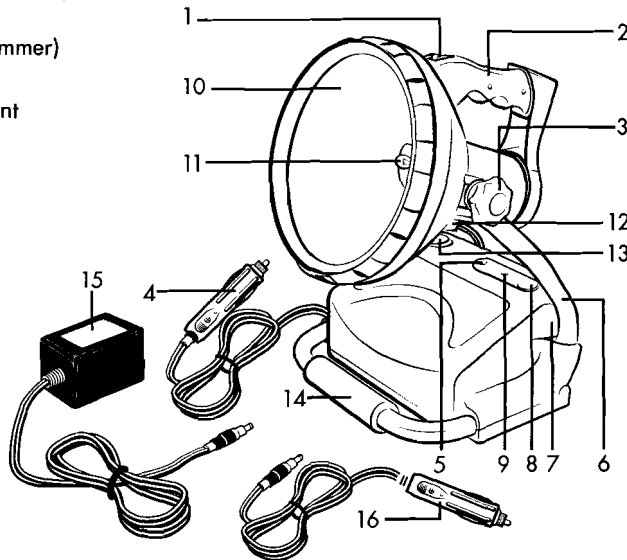

Operating Instructions

- Ensure the 12-Volt Power Cord was firmly connected from 12-Volt Power Port to Power Jack (Figure #12)
- Loosen the knobs that you can easily adjust the angles of the light as you like.
- BI-color Indicator to show the battery capacity.
- The Spotlight can work as a portable power that you can run any 12V appliances from the 12V Power Port (Figure #13)
- The Spotlight can be operated from any 12-Volt Power source directly (Figure #4)
- Both AC & DC Charger are stored in the bottom of the battery pack compartment.

Bulb Replacement

The Spotlight uses H4 12V 100W Halogen Bulb Bulb.

1. Turn off the power, unplug light and allow unit and bulb to cool.
2. Unscrew the knob.
3. Unplug the 12-Volt Power Cord.
4. Remove the screws from the back of the lens, carefully pull apart to expose the internal parts and wiring.
5. Disconnect the wire terminals of the bulb and replace the new bulb.
6. Reassemble the spotlight.

Note: Do not handle the replacement bulb with bare fingers. The bulbs are extremely hot during and immediately following use. Unplug the worklight and allow it to cool completely BEFORE attempting to change the bulbs.

Charging

When fully charged the Spotlight produces a high intensity light for approximately 50 minutes at full brightness. As the charge diminishes, the light will begin to lose its intensity.

Although the Spotlight may arrive partially charged from the factory, we recommend fully charging the unit before the first use. Once you have completed the initial charging cycle, the Spotlight is ready for normal use. For the longest battery life, be sure to recharge the Spotlight before the battery becomes fully depleted. You can determine if the spotlight requires recharging simply by turning it ON. If the light appears to have lost its intensity OR the battery indicator illuminates RED color, it's time to recharge the unit.

Charging the battery when it is partially depleted may take several hours. When the battery is fully depleted, charging the spotlight takes approximately 16 hours from AC power and 4 hours from DC power.

CAUTION: Never charge the Spotlight for more than 36 hours or damage to the unit may result.

AC Charge:

Plug the small end of the AC Adapter (Figure #15) into the AC / DC Charging Jack (Figure #5). Plug the other end of the AC Adapter into any standard AC Household outlet. Full charge takes approximately 18 hours.

12V DC Charge:

Plug the small end of the 12-Volt DC Charging Cord (Figure #16) into the AC / DC Charging Jack (Figure #5). Plug the other end of the Charging Cord into the Cigarette lighter socket that the battery will be charged while driving. Full charge takes approximately 5 hours.

Note:

- Use only the supplied AC adapter or 12-Volt Charging Cord to charge the product.
- If you plan on storing the light, we recommend that you make sure it is fully charged. This will ensure the longest possible battery life. When not in use, charge the spotlight every four months.

Specifications:

Battery:	12 volt 7 Ah Rechargeable Sealed Lead Acid Battery
Bulb:	H4 12 volt 100 Watt Halogen Bulb
Charging Time (AC Charger):	Approx. 18 Hours
Charging Time (DC Charger):	Approx. 5 Hours